

Lowdham Grange Prison

Nottingham, UK

Project Information

Client
Serco / HM Prison Service

Architect
MHK

Civil & Structural Consultant
Skanska UK

Building Services Consultant
Skanska UK

Main Contractor
Skanska UK

Dates
1996 - 1997

Construction Value
£29m

Further information

Maple Cross House
Denham Way
Maple Cross
Rickmansworth
Hertfordshire
WD3 9SW

31 Old Field Road
Bocam Park
Pencoed
Bridgend
CF35 5LJ

skanska.technology@skanska.co.uk
www.skanska.co.uk

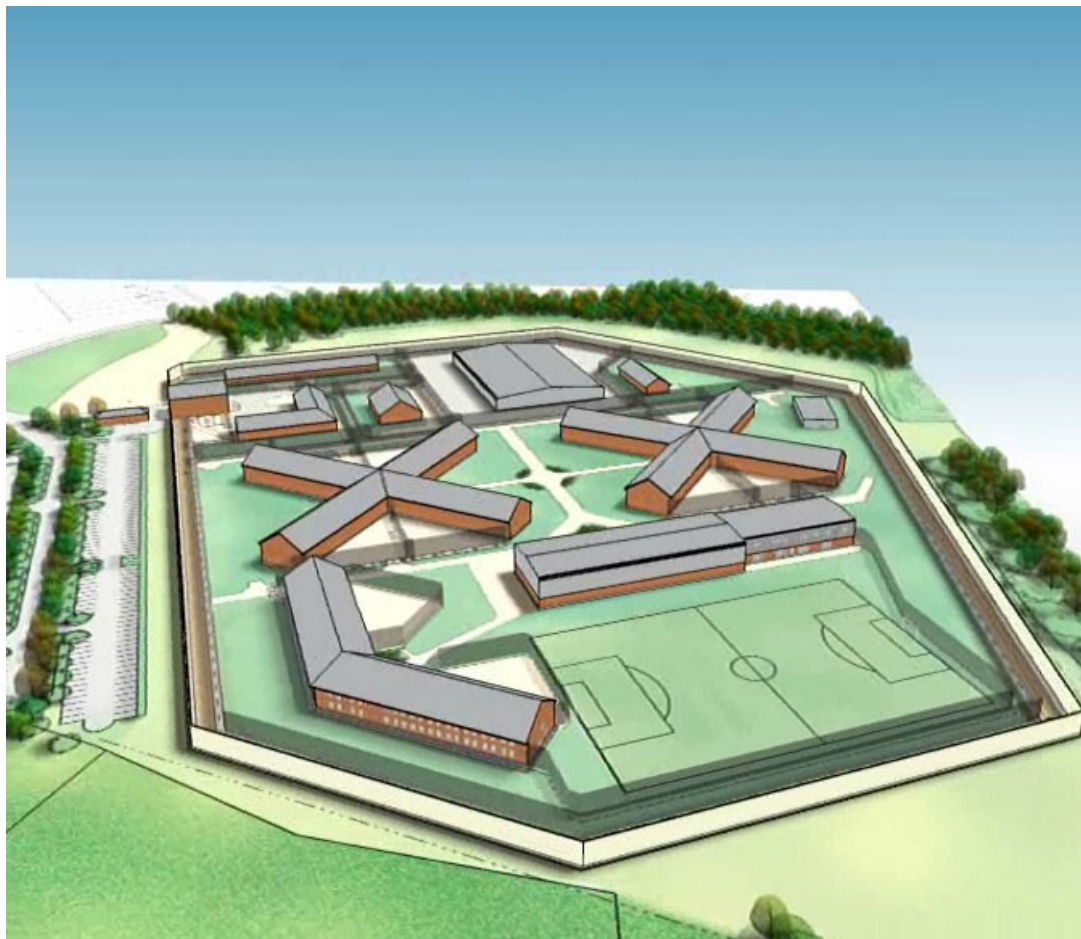

Lowdham Grange is a 600-place category B prison constructed under the Government PFI scheme and operated by Serco.

The prison provides living accommodation, sports, healthcare and education facilities, a Chaplaincy and support services.

Skanska's design team was responsible for the civil and structural designs of the prison, including external infrastructure, drainage, foundations and superstructure. The company worked with the construction team throughout the project, building on the extensive experience in the custodial sector, value engineering the design from bidding through to pre construction. □